

VJ-628

Startup Guide

Unpacking and Initial Setup

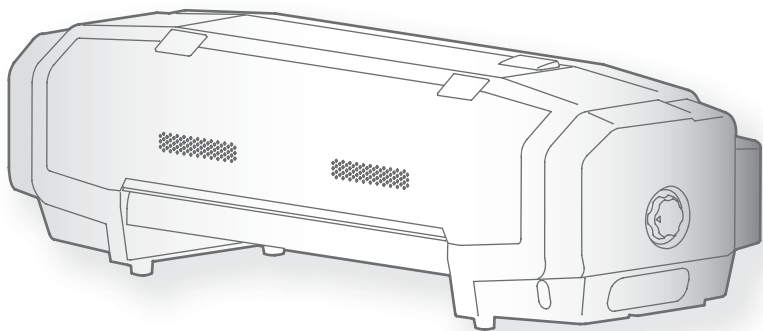

Unpacking	2
Assembly	5
Connecting the Cables	9
Setting up the Printer	11
Safety Instructions	13

-
- Unauthorized copying or duplication of the whole or part of the contents of this Guide is prohibited.
 - Every care has been taken in writing the contents of this Guide, but please contact MUTOH or the dealer you purchased the product from if you find any unclear, erroneous or otherwise unsatisfactory content in the Guide.
 - Please be aware that MUTOH will not be liable in any way for failures or accidents that result from handling or operating the printer according to any procedures other than those set forth in this Guide.
 - Company names and product names that appear in this Guide are registered trademarks of the respective companies.

Unpacking

CAUTION

- The operations of unpacking and moving this product must be carried out by two or more persons working together.
- Keep this product level when moving it.

Unpacking the printer

[1] Open the packing box and take out each part.

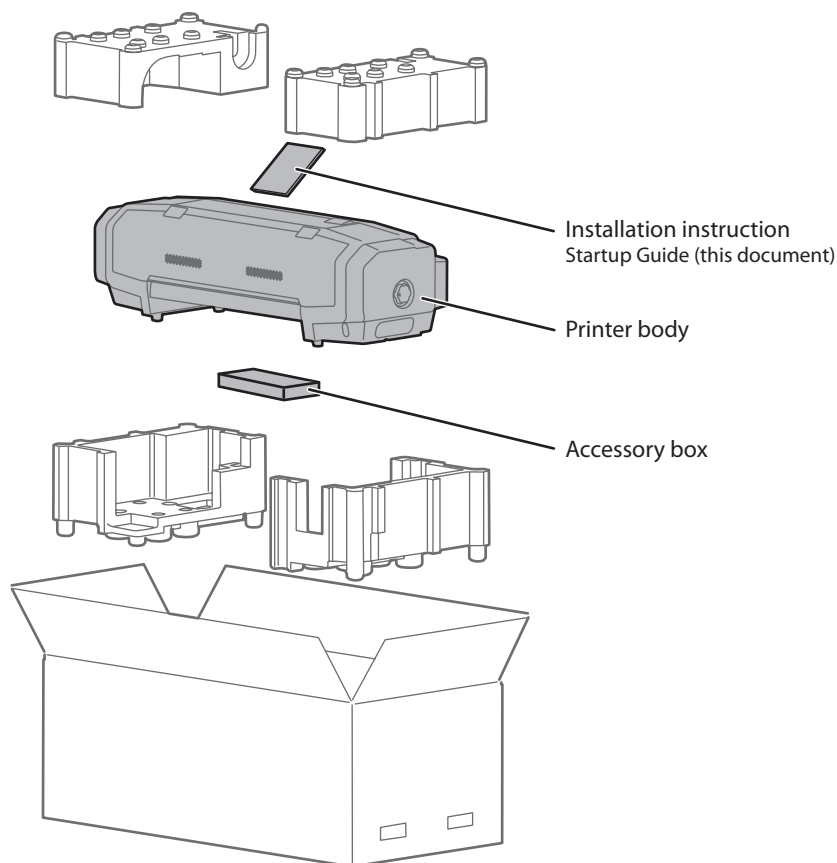

[2] Check if the followings are included.

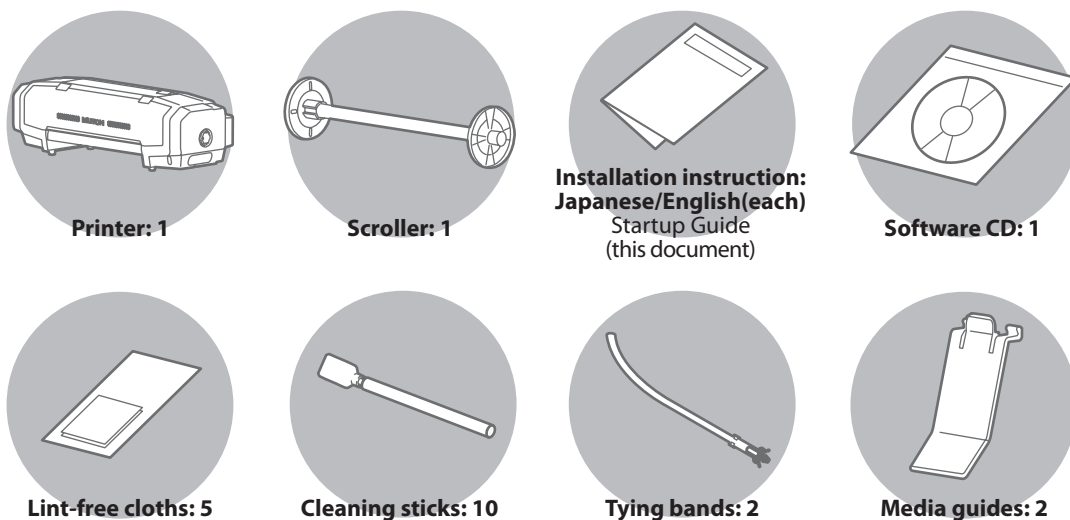

Unpacking the stand (optional)

The stand is an optional part. They are not included in the packing box of this product.

[1] Open the packing box and take out each part.

[2] Check if the followings are included.

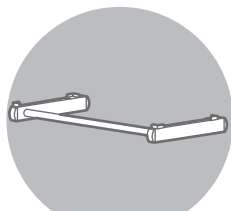

Stand top piece : 1

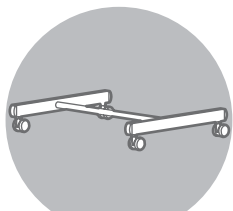

Stand bottom piece : 1

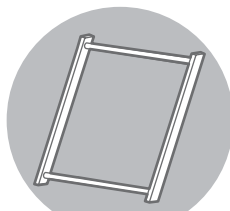

Stand middle piece : 1

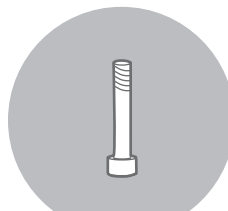

Hexagon socket head
screws : 4

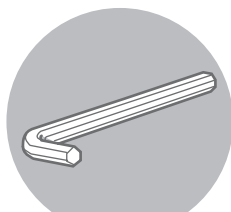

Hexagon wrench : 1

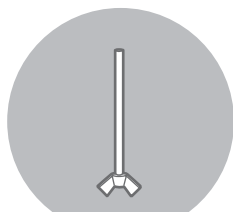

Wing screws : 2

Things to prepare in order to install and use the printer

In order to install the product and make the initial settings, you will need the following things in addition to the packaged items.



Computer: 1

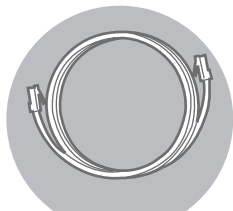

Ethernet cable: 1

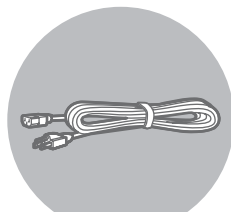

Power cable: 1

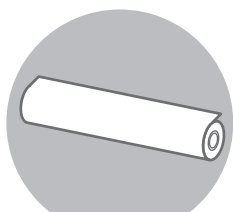

Media: 1

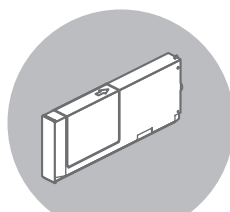

Cleaning cartridges: 8

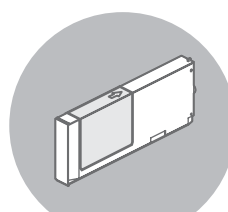

Ink cartridges: 8



Note

- Use a computer that runs one of the following operating systems:
Windows 8/8.1, Windows 7, Windows Vista, Windows XP



WARNING

- **Be sure to use a power cable of the specified type.**
Using any other power cable could result in electric shock or fire.
Contact the sales store for the specified power cable.
- **Do not use a damaged power cable.**
It could cause electric shock or fire.

Installation location

Minimum installation space

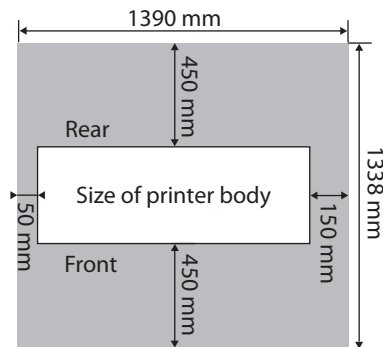

Size of printer body

width×depth: 1190 mm × 438 mm

Height(with cover open)

Without stand: 573 mm

Mounted on stand: 1373 mm

Ensuring a suitable place for installation

Install this product in a place that:

- is level
- has no vibration
- has low humidity and little dust
- has no direct sunlight or strong lighting shining on it
- has small variation in temperature and humidity
- has no drafts (including those from heating or air conditioning equipment) blowing onto it
- has low levels of electromagnetic radiation and noise



CAUTION

The place should be well ventilated when you do the installation work. If it is a poorly ventilated place, install a ventilating device.

Otherwise, the odors from the inks could impact your health.

Installation environment conditions

Install the product in an environment that satisfies the conditions in the table below.

Power supply specifications	Voltage	AC 100 V to 120 V $\pm 10\%$ or 200 V to 240 V $\pm 10\%$
	Frequency	50/60 Hz ± 1 Hz
	Capacity	No less than 10 A
Environmental conditions	Operating environment	Temperature 20 to 32 °C, humidity 40 to 60 %, no condensation.
	Ranges to ensure printing precision	Temperature 22 to 30 °C, humidity 40 to 60 %, no condensation.
	Environment for storage	<ul style="list-style-type: none">• If not charged with ink when stored: up to 6 months Temperature -20 to +60 °C, humidity 20 to 80 %.• If charged with ink when stored: up to 1 week* Temperature -10 to +40 °C, humidity 20 to 80 %. *Up to 4 days if the ambient temperature is 32 °C or higher.

Assembly

Assembling the printer and option

1. Installing the media guides and tying bands

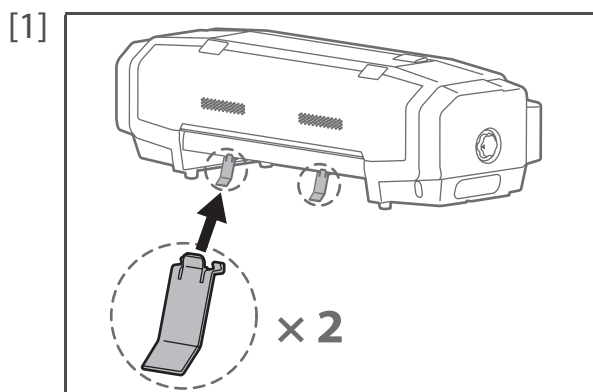

Install the two media guides in the positions shown in the figure.

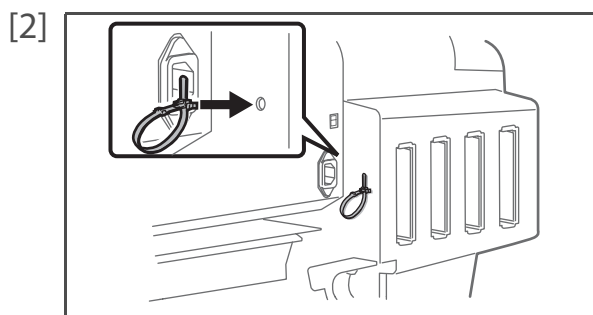

Install one of the accessory tying bands to the position shown in the figure.



Note

- To release the tying band, simply press its lever.
- This tying band is for fastening the power cable so that it will not interfere with roll media.

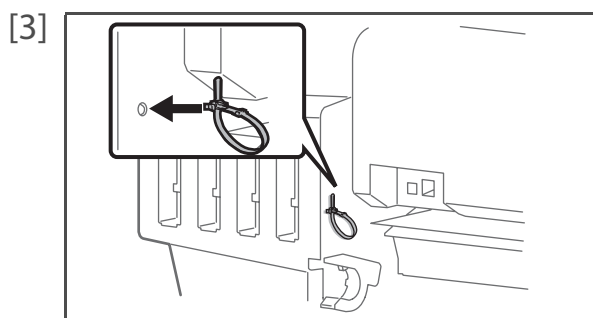

Install the other tying band on the opposite side.



Note

- This tying band is for fastening the Ethernet cable so that it will not interfere with roll media.

2. Assembling the stand (option)



CAUTION

The operation of mounting the printer onto the stand must be carried out by two or more persons working together.

[1]

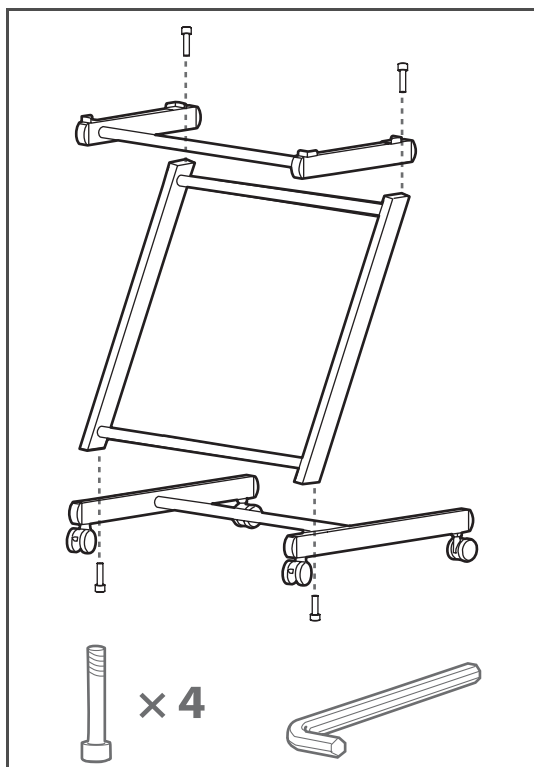

Assemble the stand.

[2]

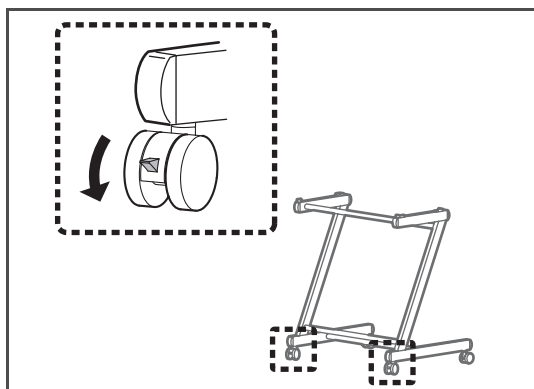

Lock the casters.

[3]

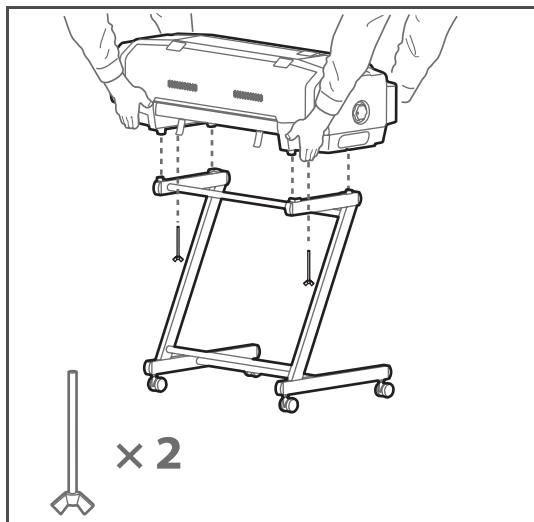

- Align the printer's rubber feet with the stand's protrusions, and mount the printer on the stand.
- Fix with 2 wing screws.

Removing the protective materials

[1] Remove all the protective materials and tapes that are stuck onto the outside of the product.

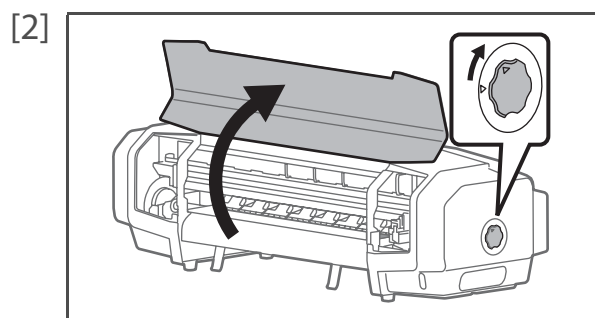

- Open the front cover.
- Turn the media fixing knob, to release the fixing mechanism.

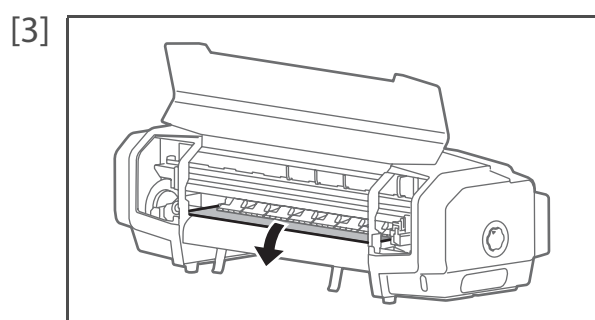

Remove the roller protective sheet.

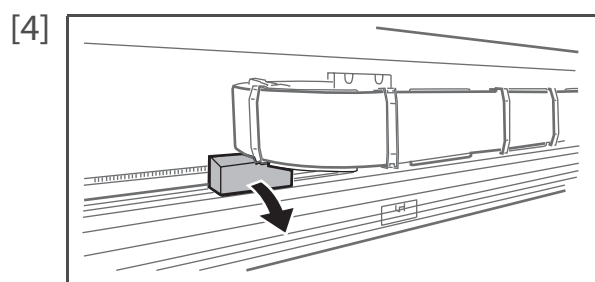

Remove the protective material for the Steel Bare.

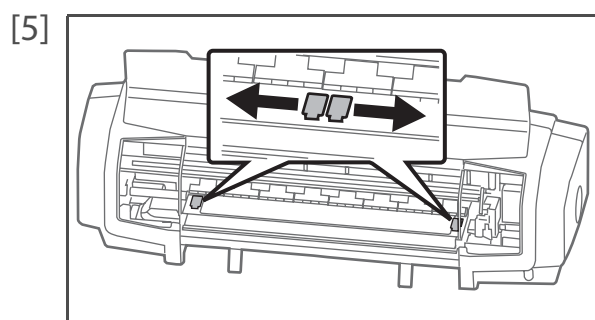

Peel away the tape, and move the left and right paper guides to their outer end positions.

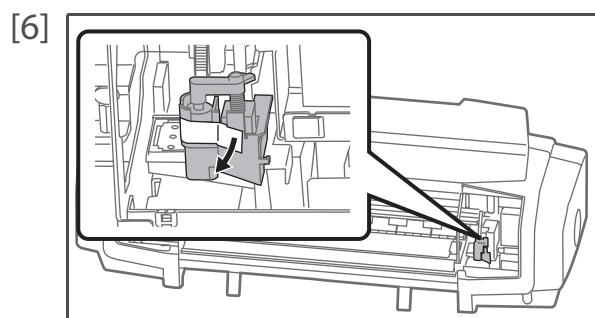

Peel off the tape fixing the cutter.

[7]

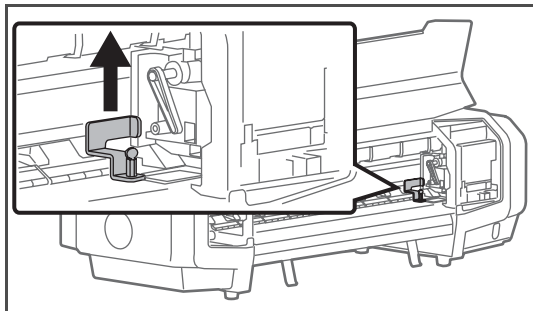

Remove the screws, and remove the head fixing plate.



Important!

- Store the roller protective sheet, head fixing plate and screws, since they are reused when transporting.

Connecting the Cables

Connecting power and Ethernet cables

1. Before connecting the cables...

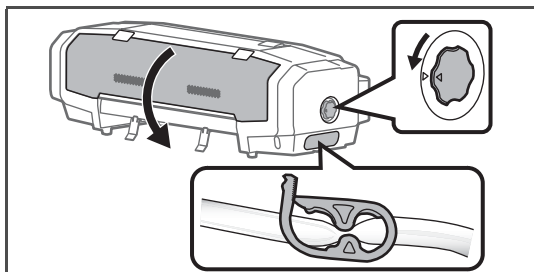

- Close the front cover.
- Turn the media fixing knob to lock.
- Check if the waste ink clip is locked.

2. Connecting the power cable

[1]

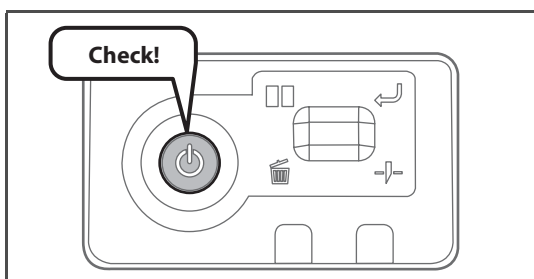

Make sure that the power button is turned off.



Note

- If the power switch is in a pressed-inward state, it is turned on and you must press it again to turn it off.

[2]

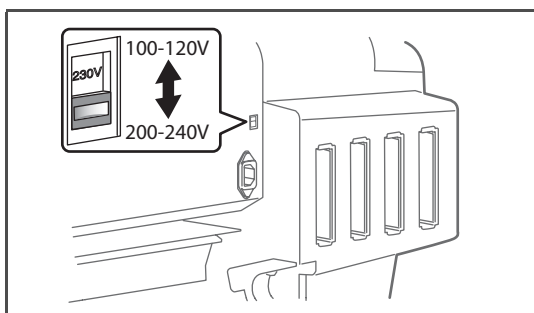

Set the voltage selector switch to the voltage of the region where you are using the product.

- For AC 100V to 120V, set the voltage selector switch to 115V.
- For AC 200V to 240V, set the voltage selector switch to 230V.



Note

- The voltage selector switch is set to 230 V when it is shipped.
- If the voltage selector switch does not match the voltage in your area, it causes errors.
For errors, refer to "Troubleshooting" in the operation manual.

[3]

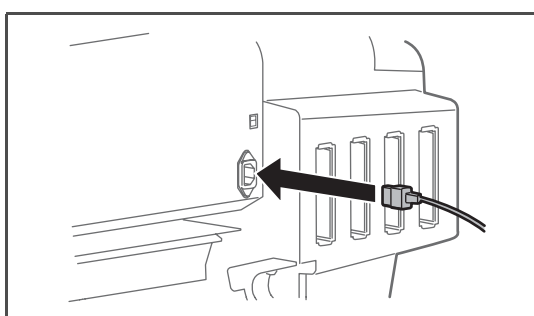

Connect the power cable to the product.

[4]

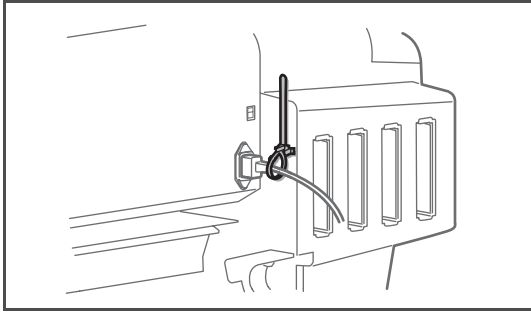

Use the tying band to fasten the power cable.

[5]

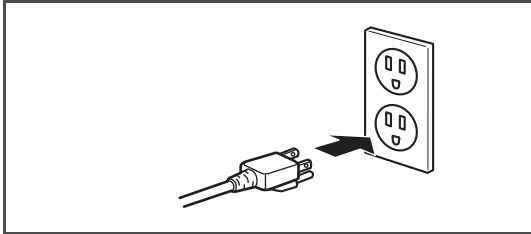

Insert the power cable's plug into the outlet. Be sure to insert it correctly.

3. Connecting the Ethernet cable

[1]

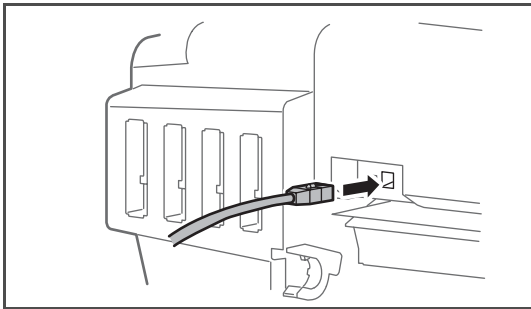

Connect the Ethernet cable to the product.

[2]

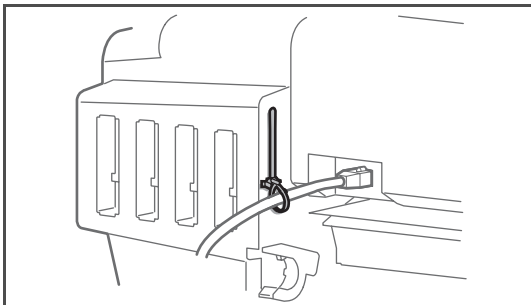

Use the tying band to fasten the Ethernet cable.

[3]

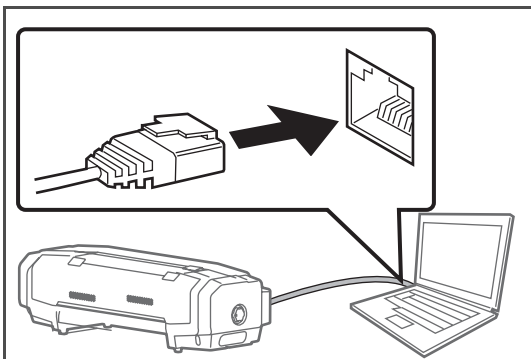

Connect the Ethernet cable to the computer.

Important!

- The left figure is the example of peer-to-peer connection between this product and computer. Connection method differs depending on the usage environment.
- If you use the product with a LAN, connect the cable so that the computer and printer are on the same subnet.

Setting up the Printer

Conduct setup referring to the set-up wizard screens.

The set-up wizard is launched from the accessory software CD.

Turn on the power

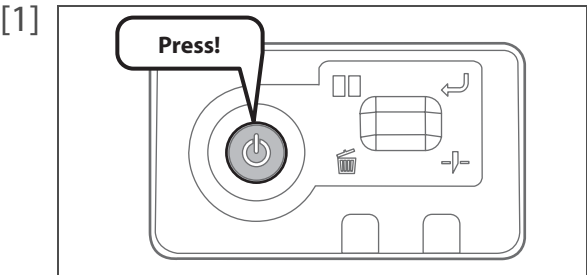

Turn on the printer's Power button.

Note

- The blue indicator will light up.
- The printer will start to power up.

Important!

Check before turning the power ON.

- Is the media fixing knob locked?
- Is the front cover closed?

Insert the software CD

The accessory software CD has the following functions.

- It displays the procedure for setting up the printer, on the computer screen (Set-up Wizard function).
- It installs the following software and data to the computer (combined installation function).

ValueJet Finder (VJ Finder)	Sets an IP address for the printer, so that it can communicate with the computer.
Printer driver	Needed for sending data from the computer to the printer. Also used for changing the print settings and at certain other times.
ValueJet Status Monitor (VSM)	Monitors the printer's status information, and is able to alter various settings. Also able to carry out initial ink charging and test printing.
Manuals(Printer and software)	To read, right click the icon of CD-ROM drive, display the contents of CD with [Open], and open each PDF of [Manual] folder.

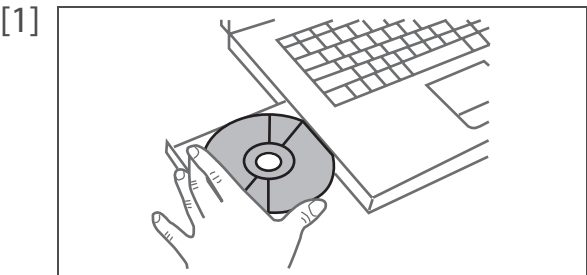

Insert the accessory CD into the computer's CD-ROM drive.

Note

- The Set-up Wizard will start up automatically.
- If the set-up wizard does not automatically start, right click the icon of CD-ROM drive, open the contents of CD with [Open], and double click VjTotalInst.exe.

[2] Carry out set-up by following the instructions on the Set-up Wizard screen.

Installation of software

Install to the computer the software that will be used with the printer.

Initial settings for software

Have an IP address set for the printer, and have the VSM initial settings and so forth implemented.

Initial ink charge

Install the ink cartridges and carry out charging with ink.

Installation of media

Install the media in order to carry out test printing.

Nozzle check and head cleaning

Run the check on the print head's nozzles, and if any nozzles are clogged, run head cleaning until they are unclogged.

Print quality adjustment

Adjust the print head's reciprocating motion to obtain the required print quality.

Paper feed correction

Adjust the feed amount for the media.

Set-up is now complete!

Safety Instructions

Important Notice

For Users in Europe



The CE marking is a mandatory European marking for certain product groups to indicate conformity with the essential health and safety requirements set out in European Directives.

By affixing the CE marking, the manufacturer, his authorized representative, or the person placing the product on the market or putting it into service ensures that the item meets all the essential requirements of all applicable EU directives and that the applicable conformity assessment procedures have been applied.

For Users in the United States

This equipment has been tested and found to comply with the limits for a Class A digital device, pursuant to Part 15 of the FCC Rules.



These limits are designed to provide reasonable protection against harmful interference when the equipment is operated in a commercial environment.

This equipment generates, uses, and can radiate radio frequency energy and, if not installed and used in accordance with the instruction manual, may cause harmful interference to radio communications.



Operation of this equipment in a residential area is likely to cause harmful interference in which case the user will be required to correct the interference at his own expense.

About the safety notices

Signification of WARNINGS and CAUTIONS

 WARNING	Used for dangerous situations where death or serious injury may be caused.
 CAUTION	Used for dangerous situations that may cause slight or medium injury, or when all or parts of products are damaged.

Meaning of symbols

Warning symbol	Meaning
	Indicates "prohibited" operations.
	Indicates required operations.



Note

- Refer to "Introduction" of operation manual for names of each component in the main body.

Concerning electric shock, short circuits and fire

WARNING



Do not install the printer where it is humid or dusty.
It could lead to an electric shock and fire.



Do not use a damaged power cable.
It could lead to an electric shock and fire.



Do not pull out or insert the power plug with a wet hand.
This could lead to an electric shock.



Do not connect an earth wire to the following places.

- **Gas pipe**
There is a possibility of ignition and explosion.
- **Earth wire of telephone cables and lightning rods**
Heavy current might flow whenever lightning strikes.
- **Water pipe and faucet**
The earth might not work if a plastic pipe is connected in the middle of the metal pipe.



Do not insert or drop metal or flammable objects into the printer through openings such as a vent.
It could lead to an electric shock or fire.



If foreign substances or liquids such as water entered the printer, do not use the printer as it is. It could lead to an electric shock or fire.
Turn the power button OFF immediately and disconnect the power plug from outlet. Then contact the customer support.



Do not place any combustible materials on the platen while the heater is working.
There may be a risk of fire.



Do not block the vent when covering the printer with cloths, such as a blanket or tablecloth.
If the vent is blocked, heat may accumulate inside the printer and may cause a fire.



Make sure to use only the specified power supply.
If a power supply other than the specified voltage is used, it could cause an electric shock and fire.



Take power for the printer directly from the power socket.
Do not use multiple plugs on the same socket. This could generate heat and might cause fire.



Be sure to use a dedicated power socket with earth wire for the power supply, and connect it to the earth wire.
If the earth wire is not connected, an electric shock or fire may occur.



Connect up the cords (cables) in the ways specified in this Guide.
Mistakes in the cable connections could result in fire.



Be sure to use the specified power cord set.

- Using a power cord set other than the specified can cause an electric shock or fire.
- Use a power cable that is equipped with a protective grounding terminal, and connect it firmly to the outlet.
- Use a power cable that conforms to the safety regulations, power supply voltage and plug shape of the country where you are using it.



Leave ink cartridge from fire or objects with high temperature.
It can cause fire.

Concerning electric shock, short circuits and fire (continued)

CAUTION



Pay attention to the following points when handling the power cord set.

- Do not tamper with the power cord set.
- Do not put heavy objects on the power cord set.
- Do not bend, twist or pull the power cord set by force.
- Do not route the power cord set near heating appliances.



Pay attention to the following points when handling the power plug.

Any mishandling of the power cable could cause a fire.

- Make sure that no foreign substances such as dust are stuck to the power plug.
- Make sure that the power plug is firmly inserted to the edge of the power socket.



Make sure that no moisture enters the printer.

It could cause shorting of the electrical circuits.



Never open covers attached using screws under any circumstances.

This may cause an electric shock or a malfunction.



Before installing the dedicated stand, be sure to turn off the printer's power and remove the power plug from the outlet.

Otherwise there will be danger of electric shock.



When you do not use the printer for a long period, make sure to pull out the power plug from the power socket for safety.



Make sure to connect an earth wire to the earth connection that meets the following standards.

- Earth terminal of power socket
- An earth wire with a copper plate which is buried at 650 mm or more in the ground.

Installing the printer

WARNING



Do not install the printer on a surface:

On such surfaces the printer could topple over or fall off, potentially causing injury.

- that is shaky, or
- that is tilted, or
- that receives vibration from other machines or equipment nearby.

CAUTION



Do not slant the printer, prop it against a wall or turn it upside down.

The ink inside the printer may leak.

Moreover, normal operation after shifting (to these positions) cannot be guaranteed.



The operations of unpacking and moving this product must be carried out by two or more persons working together.



Keep this product level when moving it.



The operation of mounting the printer onto the stand must be carried out by two or more persons working together.

Concerning handling



WARNING



Do not step on this printer or place heavy things on top of it.

It may cause an injury if the printer falls down.



CAUTION



Heed the following instructions for cleaning of the cleaning wipers and the print head outer periphery.

- **Wear goggles and/or other protective equipment, so that ink will not get in your eyes.**
- **Wear gloves, so that ink will not get directly on your hands.**
- **Do not use the same cleaning stick more than once.**
The dirt on a used cleaning stick could result in damage to the print head.



Heed the following when cleaning the cleaning wipers.

- **Do not touch the cleaning wipers or the head cap unit.**
You could get oil or grease on them, with the result that head cleaning cannot be implemented normally.
- **To wipe the cleaning wipers, use only the cleaning sticks, and use them in a dry state.**
Using the cleaning sticks wetted with water or other liquid will cause clogging of the print head.



Do not use volatile solvents such as thinner, benzene, or alcohol.

These solvents may cause damage to the paint.



- **Do not push or leave the knob of cutter quickly.**
Since there is a spring under the cutter, the cutter may pop out.
- **Do not touch the blade of cutter.**
It may cause injury.



Heed the following when cleaning the print head outer periphery.

- **NEVER touch the surfaces of the print head's nozzles.**
It could result in damage to the print head.
- **Do not touch the tip of a cleaning stick.**
You could get oil or grease on it, which could result in damage to the print head.
- **Never allow any water to get onto the tip of a cleaning stick.**
It could result in damage to the print head.



Do not operate the paper setting knob during initial operation or during printing.

It could cause the media pressure arm to interfere with the print head, and printer failure could result.



Do not touch Media feed slot, Platen, and Media guide while Heater is working.

Media feed slot, Platen, and Media guide become very hot and you could burn yourself.



Do not touch Media guide while printing.

Media guide becomes very hot and you could burn yourself.



Keep the work area well-ventilated. If the ventilation is poor, install a ventilating device.

Otherwise, the odors from the inks could adversely impact your health.

Concerning consumable items

WARNING



You are obligated to properly dispose of waste fluid from the printer in compliance with Wastes Disposal and Public Cleansing Act and local ordinances. Delegate disposal to an industrial waste disposal contractor.

CAUTION



When handling Ink cartridges, pay attention so that ink does not come into contact with your eyes or skin.

If ink gets into your eyes or sticks to your skin, immediately wash it off with water.

Failing to do so might cause irritation or light inflammation of eyes.

In case of any abnormality, consult a physician immediately.



Do not disassemble Ink cartridges.

If disassembled, there is a possibility that ink might come into contact with your eyes or skin.



During ink charging, abide by the following.

- Do not turn off the printer's power.
- Do not disconnect the printer's power cable.
- Do not open the front cover.
- Do not raise the paper setting lever.



Before operation, make sure to read the Material Safety Data Sheet (SDS).



To install a roll of paper, lay it on a level surface such as a desk.

If you install it with its scrollers in an upright position, they could be damaged.



Pay attention to the following points when cutting roll media

Mishandling Razor blade may cause a cut on your finger or hand.

- When you hold media, do not place your finger on Media cut groove.
- Move Razor blade slowly along Media cut groove.

Warning labels

There are warning labels pasted in dangerous places in this product. The contents of label are as described next and always follow them. If the labels are peeled off or become dirty, contact the sales store for exchange.

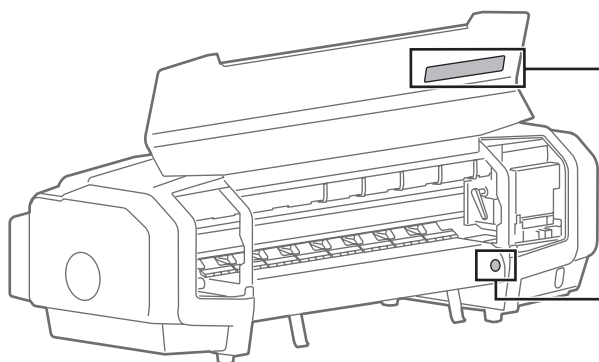

Cutter caution label

Since the cutter blade can cause injury, do not insert your fingers.



Caution label for hand insertion

Since it may cause injury when contacted with the carriage, do not insert your hand.

Concerning operation instruction labels

Operation instruction labels are stuck on the printer at places where caution in operation is required. The contents of these labels are as shown below.

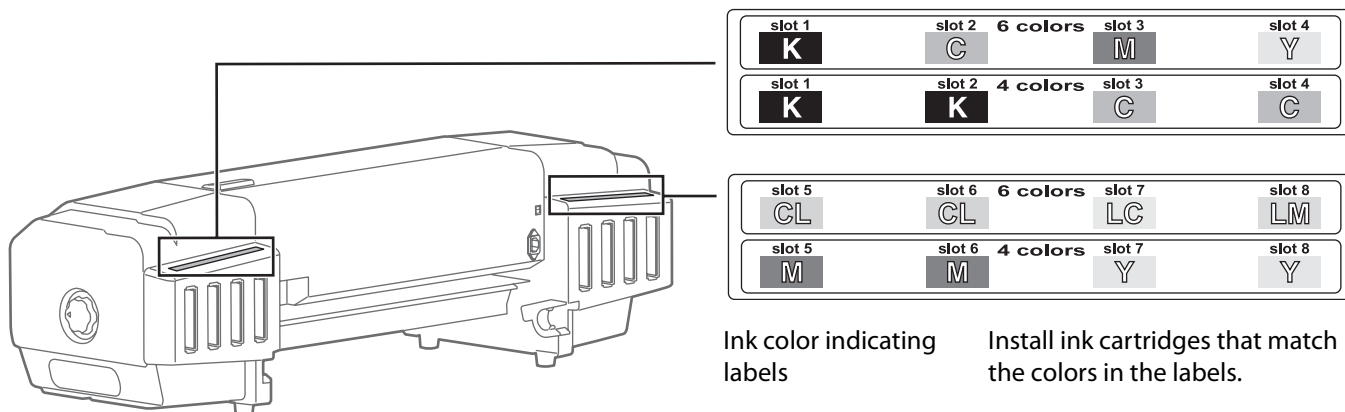

MUTOH